

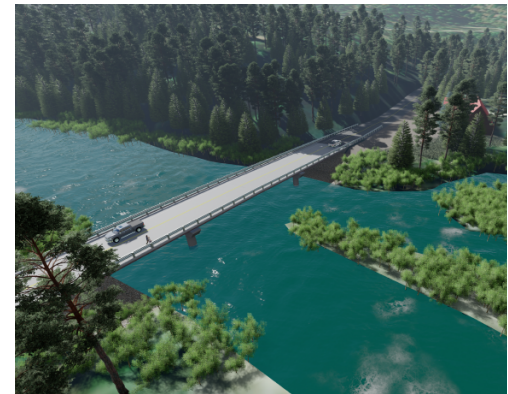

LOWMAN BRIDGE

SOUTH FORK PAYETTE RIVER

CONSTRUCTION ENDS FALL 2026

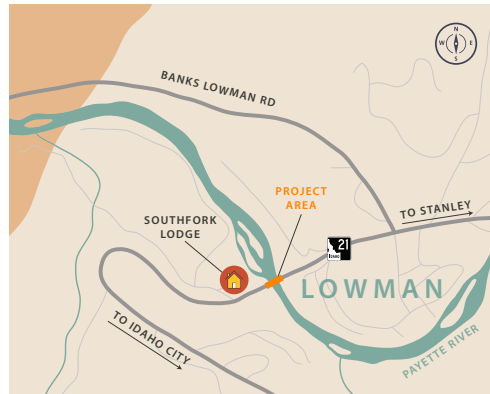

The aging Idaho Highway 21 Bridge over the Southfork of the Payette River in Lowman will be replaced with a new structure that will safely accommodate vehicle and pedestrian traffic.

To protect critical bull trout spawning habitat and reconstruct within the same footprint while maintaining through traffic, construction will span two seasons. Beginning Spring 2025, crews reconstructed the roadway adjacent to the bridge followed by demolition of the north half of the current bridge in July 2025. Traffic alternates using one lane of the existing bridge and a traffic signal while the new north section of bridge is constructed.

Construction restarted in May 2026. Between July and November 2026, traffic will shift to one alternating lane on the new bridge with signal control, while crews demolish the remaining old bridge and construct the south half of the new structure.

The new bridge is scheduled to open to traffic in both directions in fall 2026.

For more information visit

ITDprojects.org/ID21LowmanBridge