

Signing Up for the Abandoned Vehicles Portal

Version 1.0 | 01/12/26

Table of Contents

1. Introduction 2

 1.1 Purpose 2

2. Procedure 3

1. Introduction

1.1 Purpose

This guide will instruct users how to set up an account on the abandoned vehicles portal.

2. Procedure

1. Go to Towtest.itd.idaho.gov
2. Click on the blue "Sign in" button.

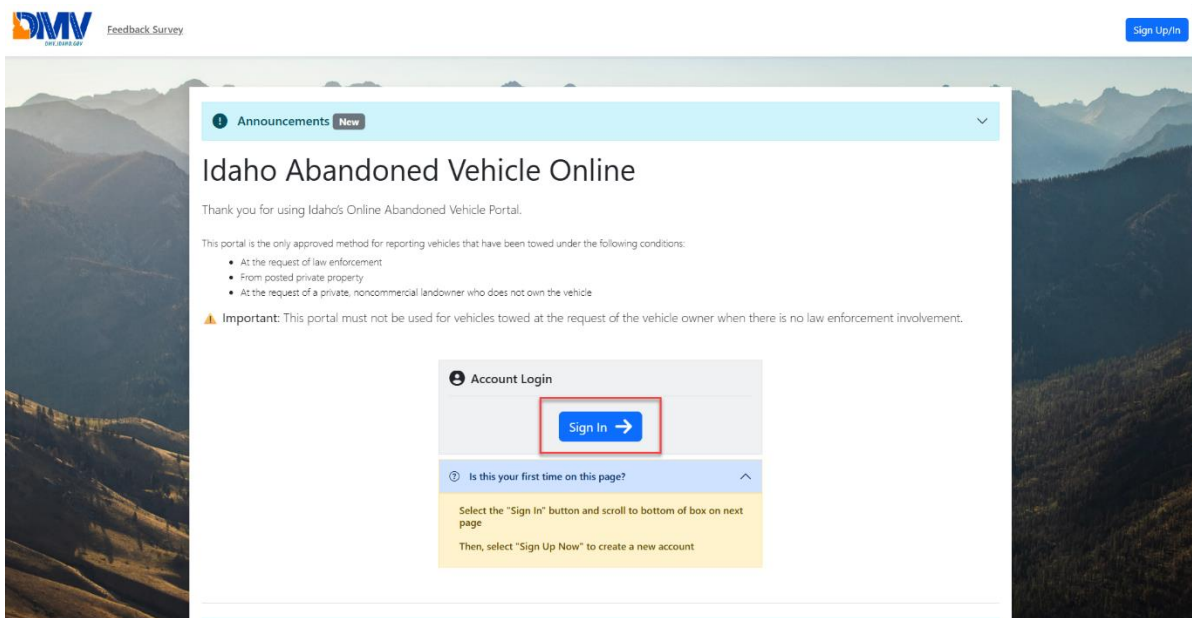

3. If you don't have an account, click the "sign up now" button.

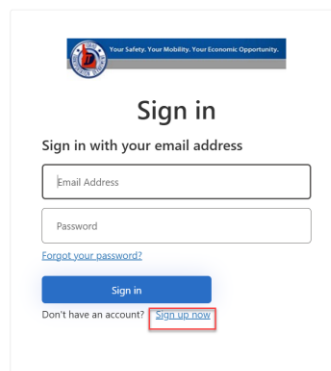

4. Next, enter your email address and press the "send verification code" button.

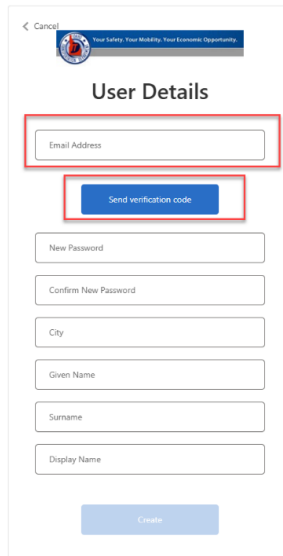

User Details

Email Address

Send verification code

New Password

Confirm New Password

City

Given Name

Surname

Display Name

Create

- a. You'll receive an from msonlineserviceteam@microsoftonline.com. Copy the verification code.

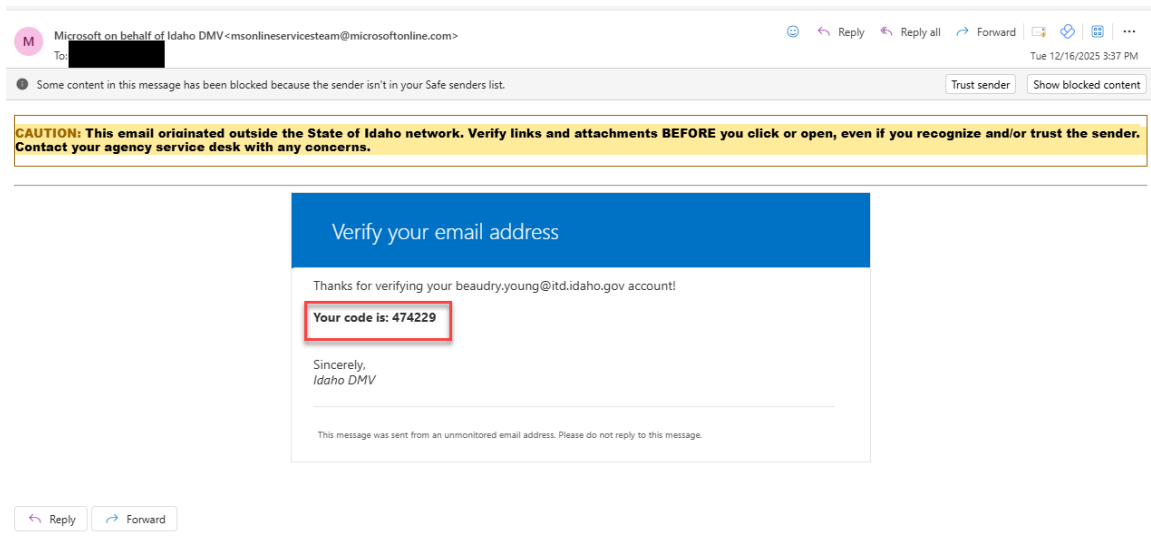

- b. Enter the verification code beneath your email address.

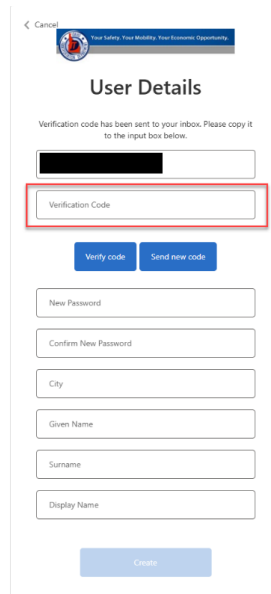

The screenshot shows a mobile app interface for 'User Details'. At the top, there's a header with a logo and the text 'Your Safety. Your Mobility. Your Economic Opportunity.' Below this, the title 'User Details' is centered. A message states: 'Verification code has been sent to your inbox. Please copy it to the input box below.' There is a blacked-out box representing the email address, followed by a text input field labeled 'Verification Code' which is highlighted with a red rectangular box. Below this are two buttons: 'Verify code' and 'Send new code'. Further down are several more text input fields: 'New Password', 'Confirm New Password', 'City', 'Given Name', 'Surname', and 'Display Name'. At the very bottom is a blue 'Create' button.

5. Create your account by entering your password, city, given name, surname, and display name.

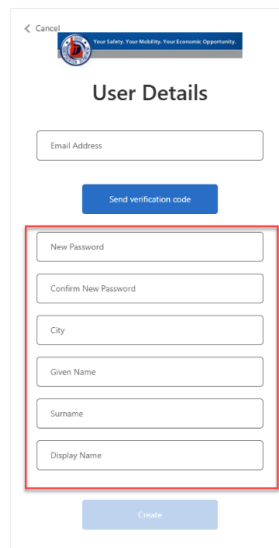

This screenshot shows the same 'User Details' form. In this step, the 'Email Address' field is filled. Below it is a blue button labeled 'Send verification code'. A red rectangular box highlights a group of input fields: 'New Password', 'Confirm New Password', 'City', 'Given Name', 'Surname', and 'Display Name'. The 'Create' button remains at the bottom.

6. Link your tow company to your profile by entering the company name (which must match what the DMV has on record), OPIN (case sensitive), and EIN or SSN (if you don't have an EIN or SSN, click the box above the link profile button).

- a. **Note:** Only the first user has to link a tow company. Later users can be added to the same company.
- b. Once you enter the information, an attestation will appear asking you to confirm that the information is true and correct. Click "I accept."

DMV Feedback Survey

Link DMV Profile to Online Account

Link Tow Company

Company Name*

OPIN (exclude dashes)* [Find your OPIN](#)

EIN or SSN (exclude dashes)*

☐ I don't have an EIN or SSN

[Link Profile →](#)

Success!

TEST WEBSITE. DO NOT USE FOR ANY REAL TRANSACTION!!!